

Pinwheel Snowflakes of Winter Joy

2009 Free "Christmas in July" 6 Month BOM Quilt Patterns from BOMQuilts.com & AbbiMays.com



Fabric Yardage - from AbbiMays.com
"Winter Joy" from Clothworks



Completed Quilt Size: 49" x 60" - Block Size: 15" finished, 15 1/2" unfinished
Fabric requirements include the quilt top, borders and binding.

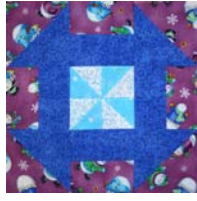

Block 2
Pinwheel
Churn Dash

Fabric	Cut (press toward the arrows)
Blue Swirls	TWO (2) 5 7/8" squares
Blue Swirls	FOUR (4) 3" x 5 1/2" strips
Purple Tossed	TWO (2) 5 7/8" squares
Purple Tossed	FOUR (4) 3" x 5 1/2" strips
White Swirls	TWO (2) 3 3/8" squares
Lt. Blue Small Snowflakes	TWO (2) 3 3/8" squares

1

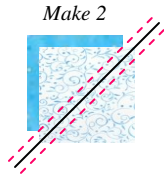

Make 2

Draw a diagonal line, corner-to-corner, on the back side of the White 3 3/8" squares. Place the squares on the 3 3/8" Lt. Blue Small Snowflakes (right sides together) and sew 1/4" on EACH side of the line you drew. Then, cut the half-square triangles apart ON the line you drew.

2

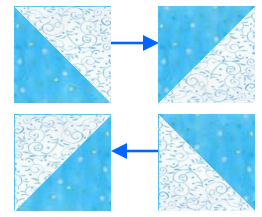

3

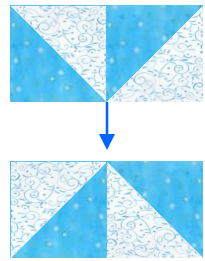

4



Make 2

Follow the same instructions from #1 above to make four (4) more half-square triangles with the Dk. Blue Swirl and Purple Tossed Squares.

5

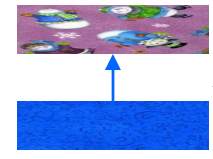

Make 4

6

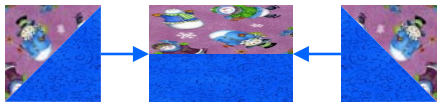

Make 2

7



8

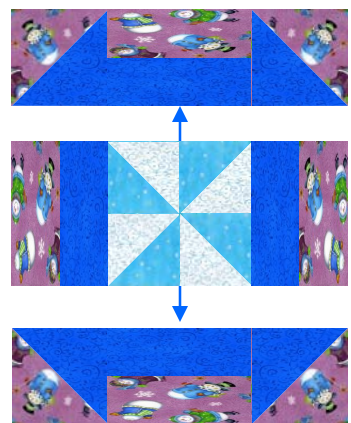

This pattern has been tested, to the best of our ability. If your block does not come out the size shown, please try adjusting your needle position to the appropriate position (left or right) and see if you get the correct block size.