

Pinwheel Snowflakes of Winter Joy

2009 Free "Christmas in July" 6 Month BOM Quilt Patterns from BOMQuilts.com & AbbiMays.com



Fabric Yardage - from AbbiMays.com
"Winter Joy" from Clothworks



Completed Quilt Size: 49" x 60" - Block Size: 15" finished, 15 1/2" unfinished
Fabric requirements include the quilt top, borders and binding.



Block 3
Pinwheel
Star

Fabric	Cut (press toward the arrows)
Blue Swirls	TWO (2) 6 1/4" squares
Purple Snowflakes	FOUR (4) 5 1/2" squares
Purple Snowflakes	TWO (2) 6 1/4" squares
White Swirls	TWO (2) 3 3/8" squares
Lt. Blue Swirl	TWO (2) 3 3/8" squares

1

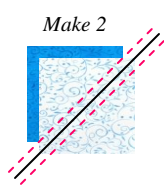

Make 2

Draw a diagonal line, corner-to-corner, on the back side of the White 3 3/8" squares. Place the squares on the 3 3/8" Lt. Blue Swirls (right sides together) and sew 1/4" on EACH side of the line you drew. Then, cut the half-square triangles apart ON the line you drew.

2

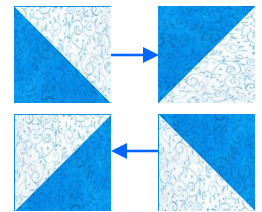

3

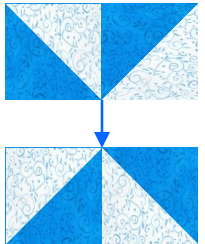

4

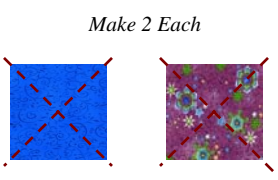

Make 2 Each

Cut the Blue Swirl and the Purple Snowflake fabric diagonally, from corner-to-corner, TWO(2) times - leaving you with 8 total triangles of each fabric color.

5

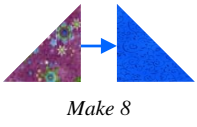

Make 8

6

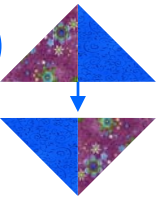

Make 4

7

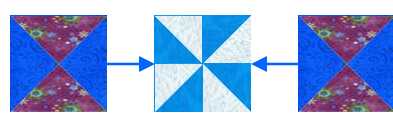

8

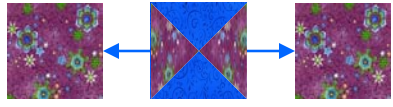

Make 2

9

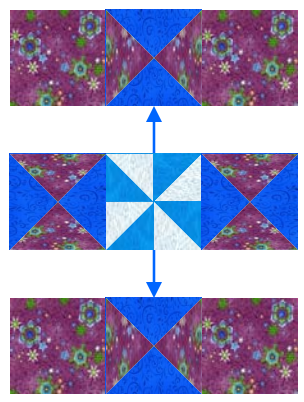

This pattern has been tested, to the best of our ability. If your block does not come out the size shown, please try adjusting your needle position to the appropriate position (left or right) and see if you get the correct block size.