

CB Chelsea Lane Sampler

2006-2007 BOM Sampler Quilt from BOMQuilts.com & CheckerBerrieQuiltShop.com

An original design of traditional sampler quilt squares surrounded by a stunning framed border designed with "Chelsea Lane" fabric by P & B Textiles.

January 25, 2007 - Block 7 - Page 1







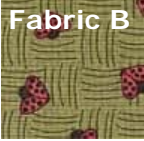

Finished Quilt to Measure 48" x 61"

Finished Blocks to Measure 14" x 14"



Cutting Instructions for Block 7

Fabric A	Fabric B	Fabric C	Fabric D	Fabric E	Fabric F
					
Cut ONE (1) 5 1/2" square	Cut EIGHT (8) 1 5/8" squares. ----- Cut ONE (1) 3 1/8" square	Cut EIGHT (8) 1 5/8" squares ----- Cut TWO (2) 3 1/8" squares then cut this square diagonally ONE time. 	Cut FOUR (4) 2 7/8" x 10 1/2" strips then cut the ends of EACH strip off at a 45% angle (see image below)	Cut THREE (3) 3 1/8" squares ----- Cut FOUR (4) 2 7/8" squares	Cut FOUR (4) 2 1/8" x 7 3/4" strips then cut the ends of EACH strip off at a 45% angle (see image below)

Measure over the SIDE size from edge and draw a diagonal line from the bottom corner to your mark. Repeat on opposite side

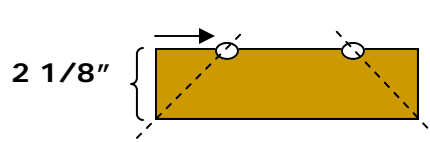
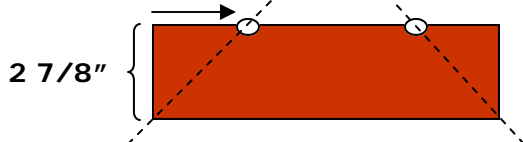

CB Chelsea Lane Sampler

2006-2007 BOM Sampler Quilt from BOMQuilts.com & CheckerBerrieQuiltShop.com

An original design of traditional sampler quilt squares surrounded by a stunning framed border designed with "Chelsea Lane" fabric by P & B Textiles.

January 25, 2007 - Block 7 - Page 2



Sewing Instructions for Block 7

- 1) Let's begin this month with some LINES! Draw a diagonal line, from corner-to-corner, on ONE (1) of your Fabric E 3 1/8" squares. Next, sew this Fabric E square to the right side of a Fabric B 3 1/8" squares, 1/4" and on BOTH sides of the line you drew. Then, cut your half-square triangles apart ON the diagonal line you drew. You will end up with TWO (2) half-square triangles.

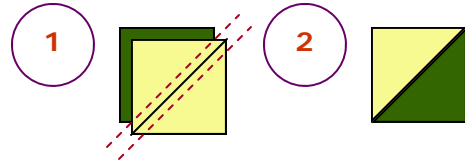

- 2) Cut the remaining TWO (2) Fabric E 3 1/8" squares in half, diagonally (corner-to-corner).
- 3) Sew your four corner four-patch blocks from Fabrics B & C as shown. Repeat three more times for a total of FOUR (4) four-patch corners:

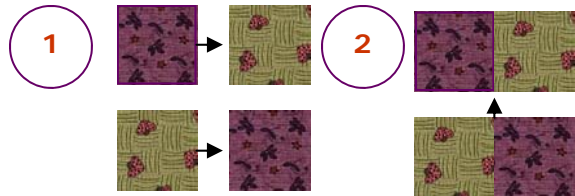

- 4) Cut the remaining TWO (2) Fabric E 3 1/8" squares in half diagonally, corner-to-corner. Sew the four corner four-patch blocks to the Fabric E triangles, as shown - make TWO (2) of these pieces:

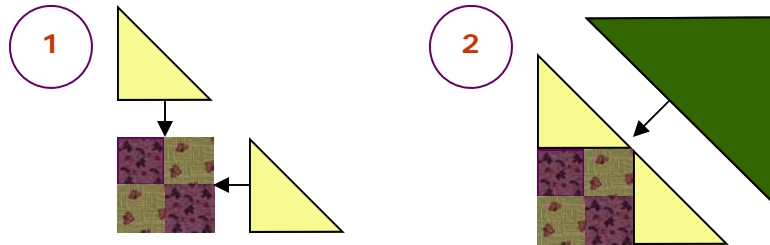

- 5) Working with the final TWO (2) four-patch corner blocks, sew them to the Fabric E 2 7/8" squares and the half-square triangles you sewed above, as shown -- make TWO (2) of these pieces:

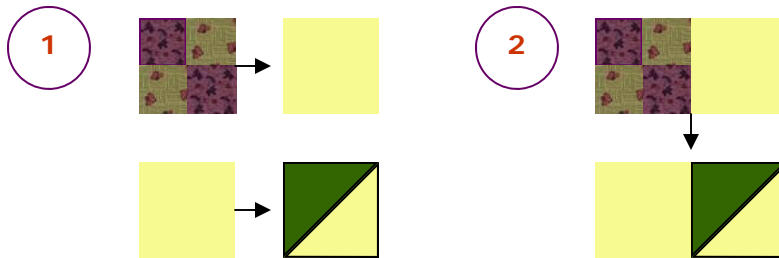

CB Chelsea Lane Sampler

2006-2007 BOM Sampler Quilt from BOMQuilts.com & CheckerBerrieQuiltShop.com

An original design of traditional sampler quilt squares surrounded by a stunning framed border designed with "Chelsea Lane" fabric by P & B Textiles.

January 25, 2007 - Block 7 - Page 3



Sewing Instructions for Block 7 (continued)

6) Now, assemble the rest of the center of your block:

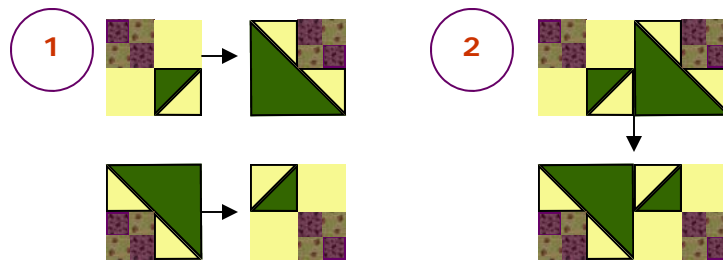

7) Finally, complete the rest of your block!

A -- sew 2 Fabric E strips to the left and right of your center half-square triangle square.

B -- sew your 4 four-square blocks to the ends of 2 of your Fabric E strips.

C -- sew the four-square strips made in B above to the top and bottom of your center half-square triangle rectangle.

D -- sew the 4 Fabric D strips to this center block.

E -- sew the Fabric F strips to the long edge of your Fabric C triangles.

F -- sew the center block to the corner triangles you made in E above!

Finished block will measure 14 5/8" square.



Now, you're ready for Block 8!

© BOMQuilts.com - All Rights Reserved
For Personal Use ONLY