

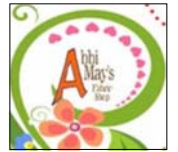

"Harry Loves Alice"

2019 Block of the Month Quilt
 An Original Quilt Design by TK Harrison, Owner of BOMquilts.com
 Brought to you by BOMquilts.com & Abbi May's Quilt Shop

BOMquilts.com



"Harry Loves Alice" is a block of the month quilt featuring the Amanda Herring for Penny Rose Fabrics / Riley Blake
www.BOMquilts.com

Finished quilt = 59" Square
 Finished Blocks for Quilt = 14" Square | Unfinished Blocks for Quilt = 14 1/2" Square

Purchase the Quilt Kit from
www.AbbiMays.com

All seams a scant 1/4" | Press in the direction of the arrows
Read ALL Instructions Before Beginning

Block #1 - Clay's Choice



Clay's Choice Quilt Block

Fabric Color	Cuts
Stitchery Green	Cut FOUR (4) 4" squares
Stitchery Green	Cut TWO (2) 4 1/2" squares. These will be paired with TWO (2) of the Lattice Navy quilt squares to create half-square triangles.
Tossed Main Cream/Red	Cut FOUR (4) 4" squares
Stars Red/White	Cut TWO (2) 4 1/2" squares. These will be paired with TWO (2) of the Lattice Navy quilt squares to create half-square triangles.
Lattice Navy	Cut FOUR (4) 4 1/2" squares. On the back side of each square draw a diagonal line, corner-to-corner, ONE (1) time.



Quilt Note: When making half-square triangles, try cutting your squares 1/4" or 1/2" larger than the pattern calls for, then trim them down to the exact size needed for your quilt block. In the case of "Clay's Choice Quilt Block," you need to trim the half-square triangles down so the are 4" square.



“Harry Loves Alice”

2019 Block of the Month Quilt
 An Original Quilt Design by TK Harrison, Owner of BOMquilts.com
 Brought to you by BOMquilts.com & Abbi May’s Quilt Shop

BOMquilts.com



Block #1 - Clay’s Choice (continued)



Clay’s Choice Quilt Block

Press in the direction of the arrows.

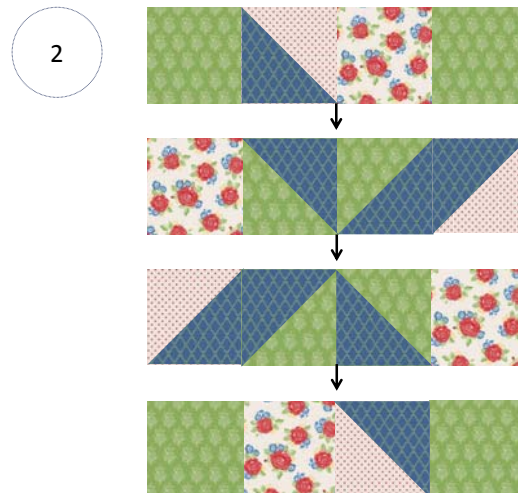
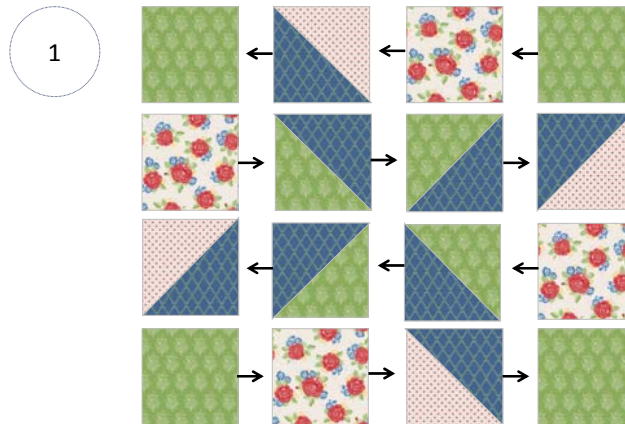

Half-Square Triangle Tutorial

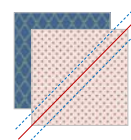

Place the Stars Red/White 4 1/2” square on the Lattice Navy 4 1/2”square (right sides together) and sew 1/4” on EACH SIDE of the line you drew. Then cut the half-square triangles apart ON the line you drew.

You will end up with TWO (2) half-square triangles. Press toward the darkest fabric. Clip your corners (aka dog ears).

Repeat this technique for remaining half-square triangles for this quilt block.

Quilt  **Note:**
 When making half-square triangles, try cutting your squares 1/4” or 1/2” larger than the pattern calls for, then trim them down to the exact size needed for your quilt block.

In the case of “Clay’s Choice Quilt Block,” you need to trim the half-square triangles down, so they measure 4” squares.