

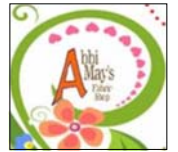

"Harry Loves Alice"

2019 Block of the Month Quilt
 An Original Quilt Design by TK Harrison, Owner of BOMquilts.com
 Brought to you by BOMquilts.com & Abbi May's Quilt Shop

BOMquilts.com



"Harry Loves Alice" is a block of the month quilt featuring the Amanda Herring for Penny Rose Fabrics / Riley Blake
www.BOMquilts.com

Finished quilt = 59" Square
 Finished Blocks for Quilt = 14" Square | Unfinished Blocks for Quilt = 14 1/2" Square

Purchase the Quilt Kit from
www.AbbiMays.com

All seams a scant 1/4" | Press in the direction of the arrows
Read ALL Instructions Before Beginning

Block #9 - Yankee Puzzle



Yankee Puzzle Quilt Block

Fabric Color	Cuts
Tiny Rose Blue	Cut TWO (2) 4 1/2" squares. These will be paired with the Tiny Rose Cream/Red 4 1/2" squares to create FOUR (4) half-square triangles.
Dots Green	Cut SIX (6) 4 1/2" squares. These will be paired with the remaining Tiny Rose Cream/Red 4 1/2" squares to create TWELVE (12) half-square triangles.
Tiny Rose Cream/Red	Cut EIGHT (8) 4 1/2" squares. On the back side of each square draw a diagonal line, corner-to-corner, ONE (1) time. TWO (2) of these will be paired with the Tiny Rose Blue 4 1/2" squares to create FOUR (4) half-square triangles. The remaining SIX (6) will be paired with the Dots Green 4 1/2" squares to create TWELVE (12) half-square triangles.



“Harry Loves Alice”

2019 Block of the Month Quilt
 An Original Quilt Design by TK Harrison, Owner of BOMquilts.com
 Brought to you by BOMquilts.com & Abbi May’s Quilt Shop

BOMquilts.com



Block #9 - Yankee Puzzle (continued)



Yankee Puzzle Quilt Block



Quilt Note: When making half-square triangles, try cutting your squares $\frac{1}{4}$ " or $\frac{1}{2}$ " larger than the pattern calls for, then trim them down to the exact size needed for your quilt block.

In the case of the “Yankee Puzzle Quilt Block,” you need to trim the half-square triangles down so they are 4" square.

Press in the direction of the arrows.

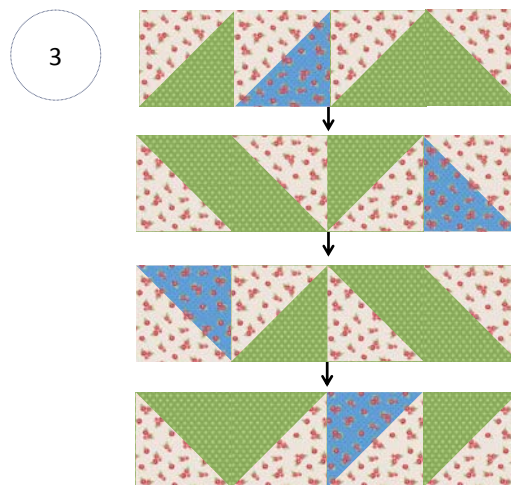
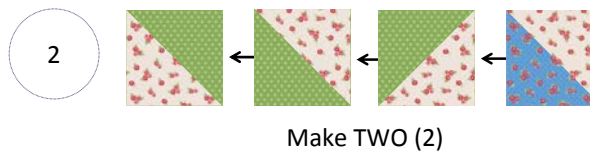
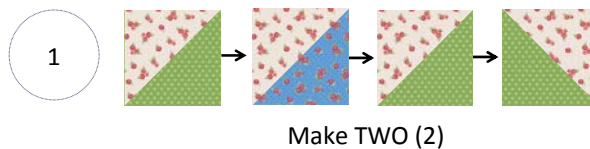

Half-Square Triangle Tutorial

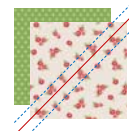

Place the Tiny Rose Cream/Red $4\frac{1}{2}$ " square on the Dot Green $4\frac{1}{2}$ " square (right sides together) and sew $\frac{1}{4}$ " on EACH SIDE of the line you drew. Then cut the half-square triangles apart ON the line you drew.

You will end up with TWO (2) half-square triangles.

Press toward the darkest fabric. Clip your corners (aka dog ears).

Repeat this technique for remaining half-square triangles, paying attention to the fabric colors, for this quilt block.