

“Mistletoe in the Corner”

2006 BOM Quilt

An Original Quilt Design by TK Harrison from BOMquilts.com!

BOMquilts.com



**Block #8 -
Nine-Patch
in the
Corner**

[www.BOMquilts.com!](http://www.BOMquilts.com)

Finished quilt = 53 1/2" square
Finished Blocks for Quilt = 14 1/2"
Unfinished Blocks for Quilt = 15"

All seams a scant 1/4".
Press in the direction of the arrows.

Read ALL Instructions Before Beginning

Cutting Instructions for a ONE (1) 14 1/2" finished & 15" unfinished quilt block:

Fabric Color	Cut #1	Instructions or Cut #2
Dk. Pink	Cut FOUR (4) 2 7/8" squares.	N/A
White	Cut FOUR (4) 2 7/8" squares.	N/A
Dk. Brown	Cut ONE (1) 2 7/8" square.	N/A
Dk. Brown	Cut ONE (1) 8 1/8" square.	Then cut the square diagonally, corner-to-corner, ONE (1) time. Will yield TWO (2) triangles.
Dk. Pink	Cut ONE (1) 15 3/8" square.	Then cut the square diagonally, corner-to-corner, ONE (1) time. Will yield TWO (2) triangles. Only ONE (1) of these triangles is needed for this quilt block. But don't get rid of it! Save it for one of the other blocks in this quilt.



“Mistletoe in the Corner”

2006 BOM Quilt

An Original Quilt Design by TK Harrison from BOMquilts.com!

BOMquilts.com



**Block #8 -
Nine-Patch
in the
Corner**

[www.BOMquilts.com!](http://www.BOMquilts.com)

Finished quilt = 53 1/2" square
Finished Blocks for Quilt = 14 1/2"
Unfinished Blocks for Quilt = 15"

All seams a scant 1/4".
Press in the direction of the arrows.

Read ALL Instructions Before Beginning

Piecing Instructions for Block #8- Nine-Patch in the Corner

Please refer to the “Tutorials” link on the BOMquilts.com website in order to create this quilt block!

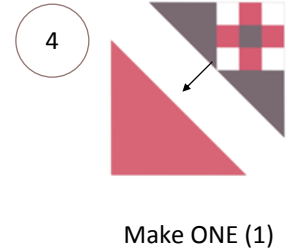
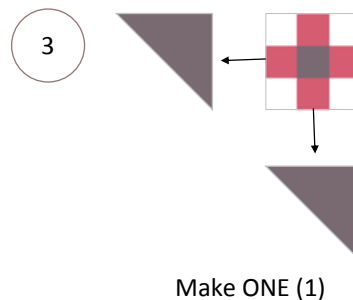
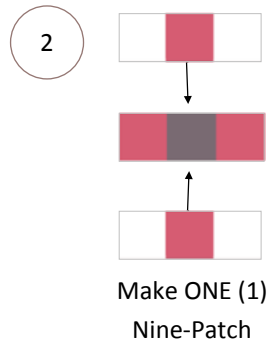
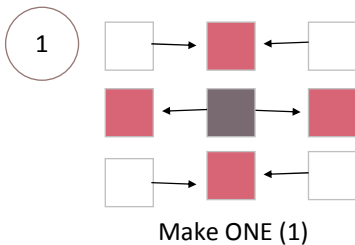

Stay Tuned for Block #9 - Candy Stripe in the Corner